



## Baseball Line Score with Pitch Count

AT BAT	4	BALL	3	STRIKE	2	OUT	2	H/E	H
	1	2	3	4	5	6	7	8	9
	10								
								R	H
								E	

PITCHER	
GUEST	HOME
14	18

GUEST	0	0	2	0	1	0					3	7	2
HOME	0	1	0	3	0	0					4	9	1

  

PITCH COUNT	
GUEST	HOME
104	39

OVERALL DIMENSION	8' high x 28'-4" wide x 4.7" deep (including built-in mounting channel).									
INFORMATION DISPLAYED	Home and Guest Score, Ball, Strike, Out, Innings, Hits, Errors, Hit/Error w/ Position, At Bat, Pitcher, Pitch Count. <i>Information may vary depending on variations.</i>									
DIGITS	18", 16", 12" Bright Red, 7-Segment LEDs.									
INDICATORS	None.									
CAPTIONS	White vinyl letters.									
HORN	Horn not included. External 100 dB Vibrating Horn or 120dB Trumpet Horn are available.									
CONSTRUCTION	Extruded aluminum frame, .093" thick, mill finish. Faces made from 22ga galvalume steel with shatter proof polycarbonate windows. Backs made from 22ga galvanized steel.									
STANDARD COLORS (Custom Colors Available)	<table><tr><td>BLACK</td><td>NAVY</td><td>BLUE</td><td>LIGHT BLUE</td><td>PURPLE</td><td>BURGUNDY</td><td>RED</td><td>FOREST GREEN</td><td>GREEN</td></tr></table> <p>Black, Navy, Blue, Light Blue, and Red have a Kynar® finish, other standard and custom colors are powder coated or painted enamel.</p>	BLACK	NAVY	BLUE	LIGHT BLUE	PURPLE	BURGUNDY	RED	FOREST GREEN	GREEN
BLACK	NAVY	BLUE	LIGHT BLUE	PURPLE	BURGUNDY	RED	FOREST GREEN	GREEN		
ELECTRONICS	100% solid state, microprocessor controlled system.									
SERVICING	Front access for ease of servicing. Plug in modules for ease of replacement.									
MICROPROCESSOR CONTROL CONSOLE	Sold separately. Extruded Aluminum, high impact low profile microprocessor control console, latest state of the art, user friendly. Size: 13.25" wide x 5" high x 9" deep. Weight: 6 lbs. Microprocessor to be supplied with 25 feet of cable (hardwire). Microprocessor control console with membrane keyboard provides for direct entry of all information. Radio Control is available.									
JUNCTION BOX	One outdoor rated junction box, 5" x 3" with cover and ethernet cable. (Hardwire)									
DATA CABLE	Twisted pair, direct burial, RJ45 Connectors (Hardwire).									
POWER REQUIREMENTS	115/230 VAC. 50/60 Hz. Minimum one 20A circuit is recommended.									
INSTALLATION	All standard variations typically installed on three posts. Mounting kits are supplied with scoreboard. <i>NOTE: Number of posts must be determined locally by licenced engineer.</i>									
WEIGHT	Net 1080 lbs / Shipping 1430 lbs.									
WARRANTY	Five year guarantee against defects in materials and workmanship. Factory repair service for parts in warranty. Union label. UL Certified.									

### Typical Multi-Cabinet Scoreboard Installation Illustration

NUMBER OF POLES SHOWN ONLY FOR REFERENCE. MUST BE DETERMINED LOCALLY BY LICENCED ENGINEER.

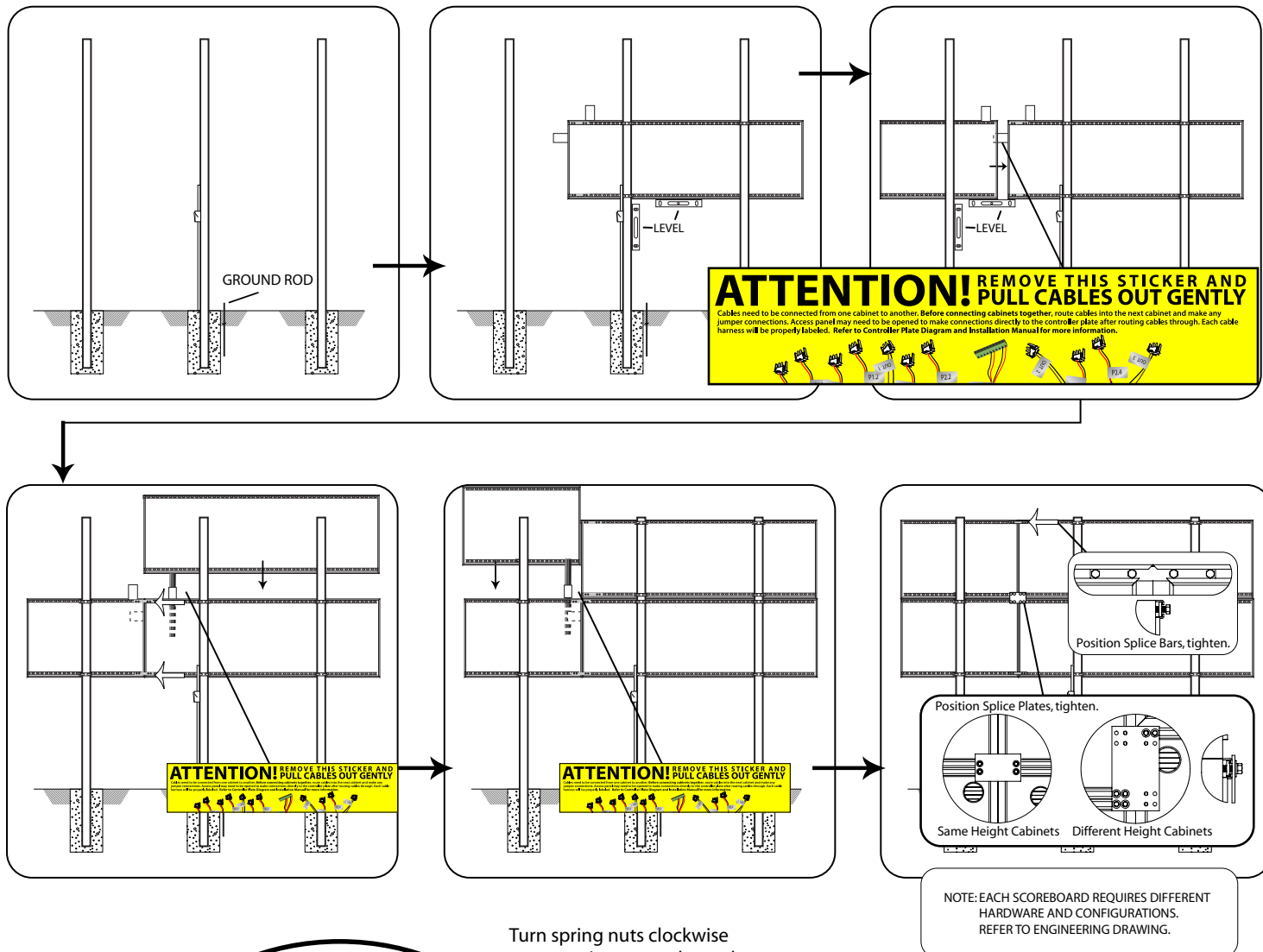

Turn spring nuts clockwise to secure into strut channel.

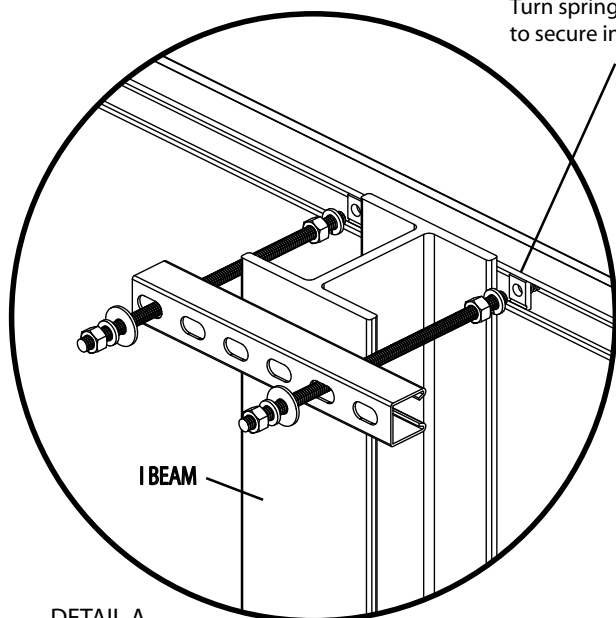

DETAIL A.  
Pressure hold scoreboard cabinets to poles.  
Secure with weld.

#### Mounting Kit

Quantity of kits depends on board and number of poles required.  
Installed at every point where a pole and a strut channel intersect.  
Local ordinances, soil conditions and wind load requirements may require additional structure.

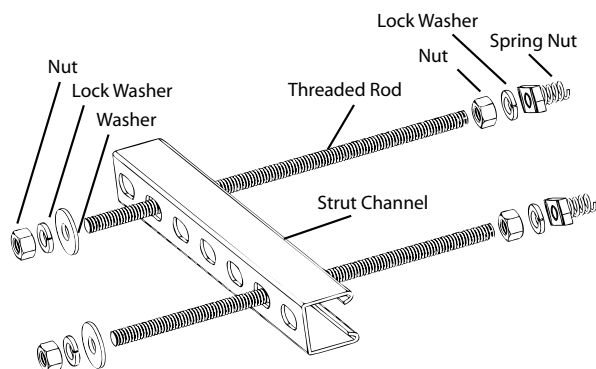

# Hardwire Scoreboard Wiring

## With a Standard Junction Box

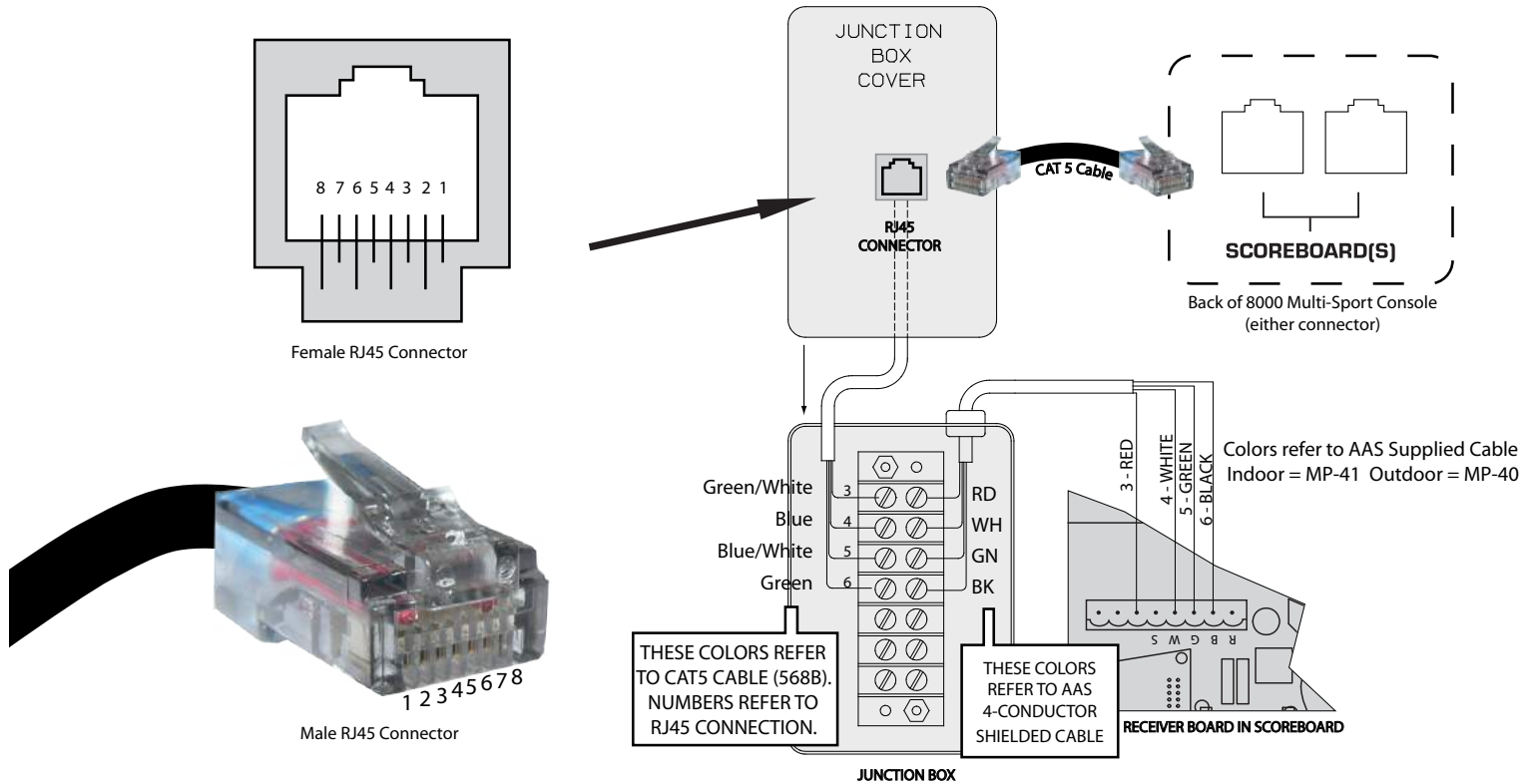

# Wiring a Supplemental Display

## With a Single Junction Box

